

# HONDA XADV '21

REF 20998N

PORTAMATRÍCULA / LICENSE SUPPORT / KENNZEICHENHALTER



1 Person



1 hour



INTERMEDIATE

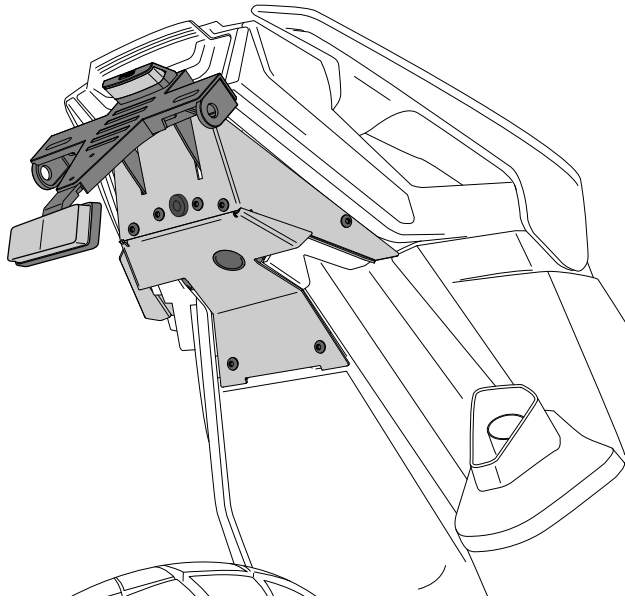

CONSULTAR EN NUESTRA PAGINA WEB LA DISPONIBILIDAD DEL VIDEO DE MONTAJE DE ESTA REFERENCIA.  
CONSULT OUR WEBSITE THE VIDEO MOUNT AVAILABILITY OF THIS REFERENCE.

Accesorio verificado en la configuración básica de la motocicleta. Para modelos con configuraciones extras de fábrica. No podemos asegurar su compatibilidad, salvo consulta previa. Declinamos cualquier eventual reclamación.  
Accessory verified in the basic configuration of the motorcycle. For models with extra factory settings. We cannot assure its compatibility, except for prior consultation. We decline any eventual claim.

ID.	PIEZA / PART	DESCRIPCIÓN	DESCRIPTION	QTY.	REF.:
1		Soporte portamatrículas	License support	1	CONJUNTO--20998N
2		Tornillos M8x15 DIN912 (Negro)	M8x15 DIN912 screw (Negro)	4	TORNI-AD912-049
3		Tornillos M5x10 DIN1001 (Negro)	M5x10 DIN1001 screw (Negro)	6	TORNI-AI----520
4		Tornillos M5x16 DIN1001 (Negro)	M5x16 DIN1001 screw (Negro)	2	TORNI-I7380-493
5		Tuercas enjauladas M5	M5 caged nut	2	TUERCAJFM5-0373
6		Silentblock goma	Rubber silentblock	1	SILENBGONE--064
7		Brida de plástico	Plastic bridle	5	BRIDAN100X2'5N
8		Luz portamatrículas	Back light	1	5577N
9		Catadrióptico	Reflector	1	4481R
10		Tapon cabota tornillo M6 DIN1001	M6 DIN1001 screw cap	4	TAPON-----85
11		Tapon cabota tornillo M5 DIN1001	M5 DIN1001 screw cap	9	TAPON-----86

# HONDA XADV '21

REF  
20998N

INSTRUCCIONES DE MONTAJE - MOUNTING INSTRUCTIONS - MONTAGEANLEITUNG

**1**

ASSEMBLY  
MONTAJE

**A** Piezas originales  
Original parts

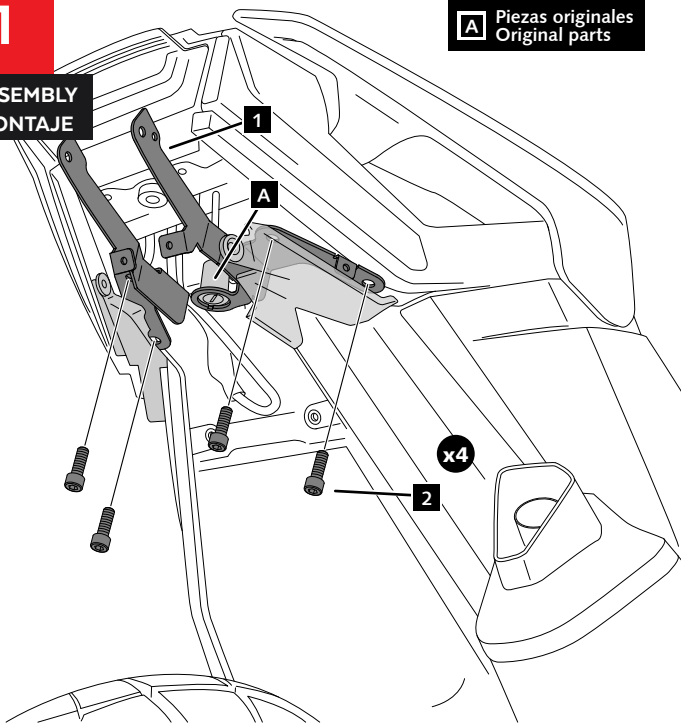

**2**

ASSEMBLY  
MONTAJE

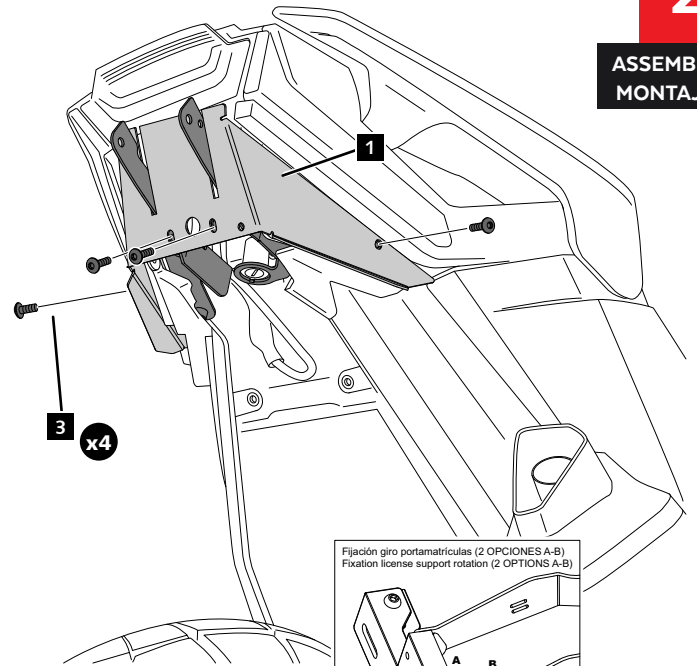

Fijación giro portamatriculas (2 OPCIONES A-B)  
Fixation license support rotation (2 OPTIONS A-B)

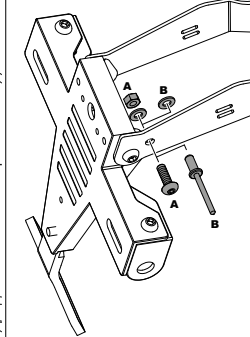

**3**

ASSEMBLY  
MONTAJE

**A** Tornillería original  
Original screws

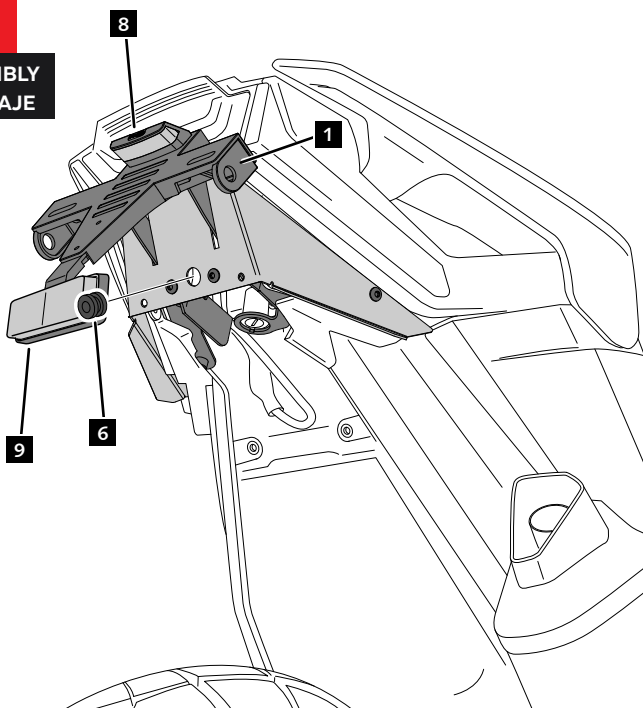

**4**

ASSEMBLY  
MONTAJE

